

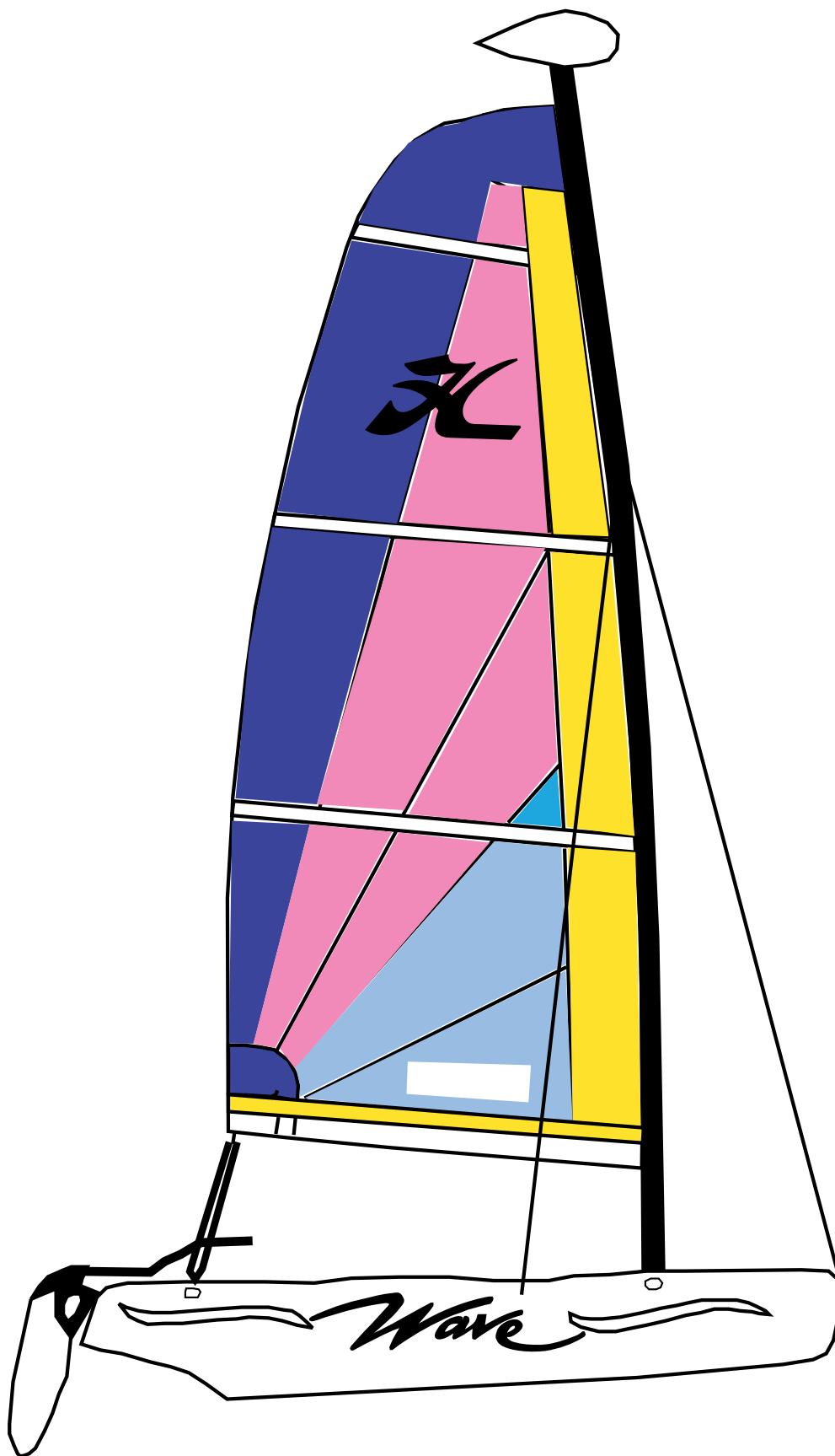

Eclaté des pièces détachées

Illustrated Part Guide - Explosionszeichnung



HC WAVE Club

Coque/Hull/Rumpf

Coque complète/Complete hull/Rumpf komplett

99056122 : Gauche/Left/Links

99056121 : Droite/Right/Rechts

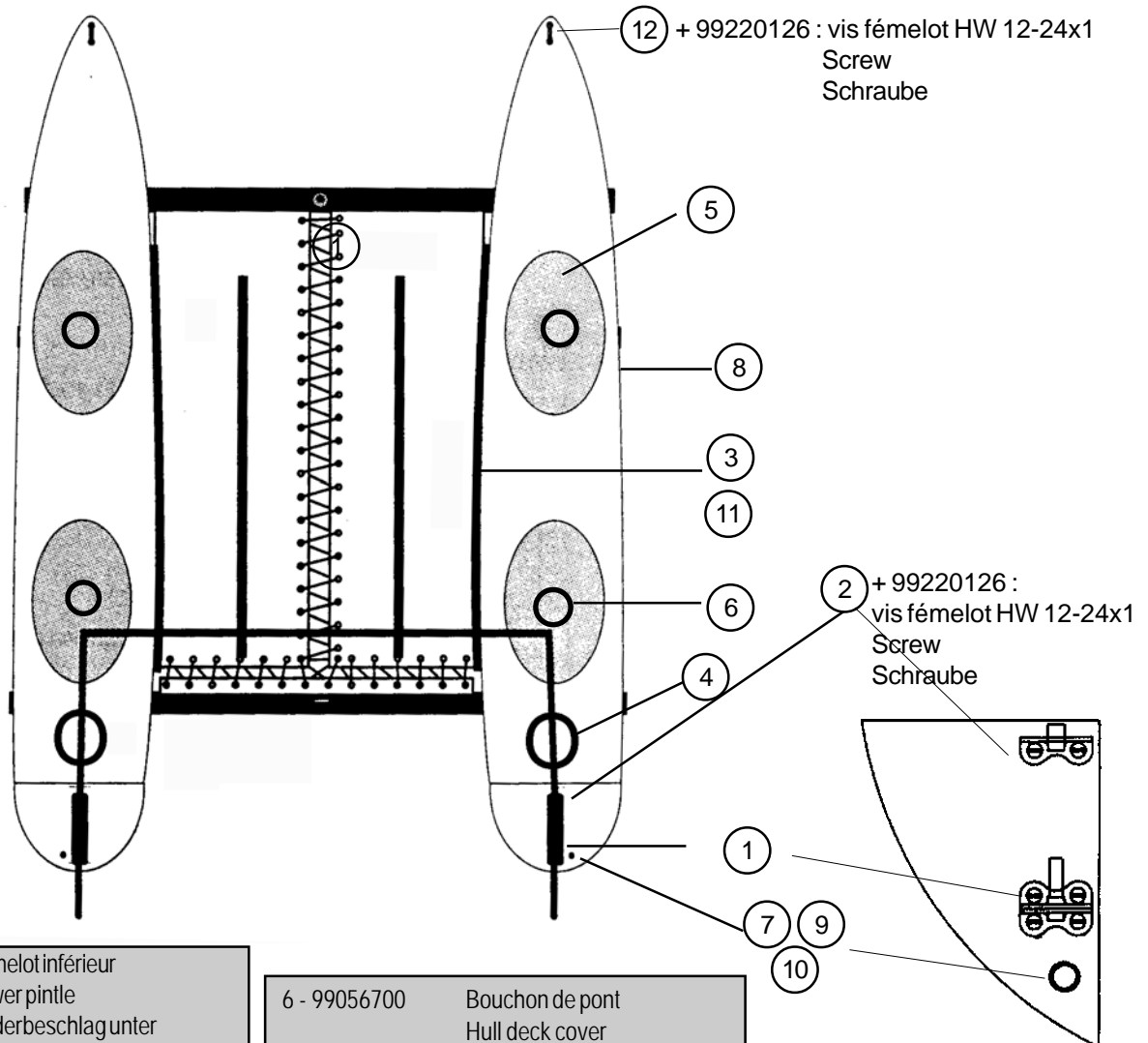

1 - 99056047 (2007)	Fémelot inférieur Lower pintle Ruderbeschlag unter
99061710 (2008)	Fémelot 4 trous Pintle 4 screws Ruderbeschlag 4 Schraube
2 - 99056048 (2007)	Fémelot supérieur Upper pintle Ruderbeschlag ober
99061705 (2008)	Fémelot 2 trous Pintle 2 screws Ruderbeschlag 2 Schraube
3 - 99056049	Rail de trampoline Trampoline track Trampolineschiene
4 - 18056033	Trappe de visite Inspection port cover Luckendeckel
5 - 99056705	Tapis antidérapant Seat pad Sukzbatte

6 - 99056700	Bouchon de pont Hull deck cover
7 - 99056710 (old)	Bouchon de vidange + joint Drain plug + gasket Ablaßschraube + Dichtung
8 - 99061400	Cadène de hauban Chain plate Putting
9 - 99056232 (x10)	Bouchon de vidange Drain plug Ablaßschraube
10 - 99220048 (x10)	Joint Gasket Dichtung
11 - 99220114	Vis rail de trampoline Screw trampoline track Schraube Trampolineschiene
12 - 14070325 (x10)	Pontet Eyestraps Bügel

HC WAVE Club

Gouvernail/Rudder assembly/Ruderbeschlag

Gouvernail complet/Rudder assembly complete/
Ruderbeschlag komplett :

Droite/Right/Rechts = 99062115

Gauche/Left/Links = 99062110

2007

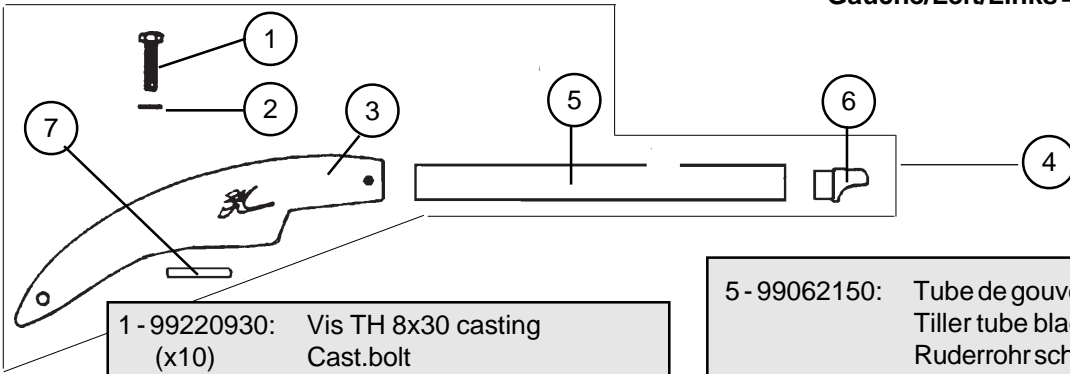

- 1 - 99220930: Vis TH 8x30 casting
(x10)
Cast.bolt
Schraube Gußteil
- 2 - 99220750: Rondelle plate D8
(x10)
Washer D8
Unterlegscheibe D8
- 3 - 17000010: Casting supérieur gouv.
Upper rudder casting
Oberes Rudergehäuse
- 4 - 99062121: Bras gouv.droit complet
Tiller arm right complete
Ruderarm rechts komplett
99062120: Bras gouv.gauche complet
Tiller arm left complete
Ruderarm links komplett

- 5 - 99062150: Tube de gouvernail nu noir
Tiller tube black bare
Ruderrohr schwarz
- 6 - 99000005: Embout à rotule
Tiller end cap
Ruderarmendstück
- 7 - 14061122: Platine dural
Cam stop plate
Platine f. oberes Rudergehäuse
- 8 - Came safran/Plastic cam/Rudernock
14061183 (x10)
14061170 (x3) + penne/plunger
- 9 - 16041756: Goupille élastique
(x10)
Maststep pin
Sprengbolzen

Hobie Cat Wave : Eclaté de pièces détachées / Illustrated part guide/Explosionszeichnung (2007-2008)

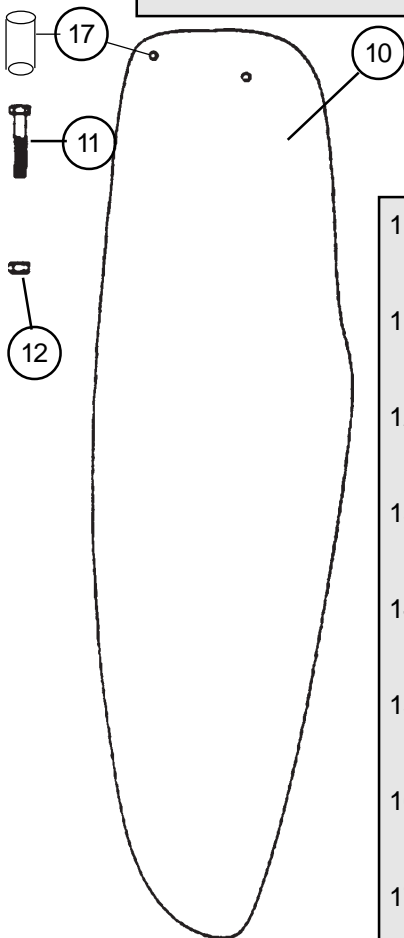

- 10 - 18062180: Lame safran Lexan
Ruder blade Lexan
Ruderblatt Lexan
- 11 - 99220940: Vis safran TH 8x55
(x10)
Rudder bolt
Schraube Ruderblatt
- 12 - 99056239: Ecrou indessérable D8
(x10)
Nylstop nut
Selbstsichernde Mutter
- 13 - 18000155: Casting inf. gouv
Lower rudder casting
Unteres Rudergehäuse
- 14 - 14061106: Pene safran
(x10)
Plunger
Gegenstück Rudernock
- 15 - 99220685: Ressort inox
(x10)
Spring
Feder
- 16 - 99220825: Vis safran delrin
(x10)
Tension screw
Delrinschraube
- 17 - 99502160: Insert lame de safran
Sheave pin rudder blade
Bolzen Ruderblatt
- 18 - 17062680: Casting inf. gouv. monté
Lower rudder cast. assembly
Unteres Rudergehäuse montiert

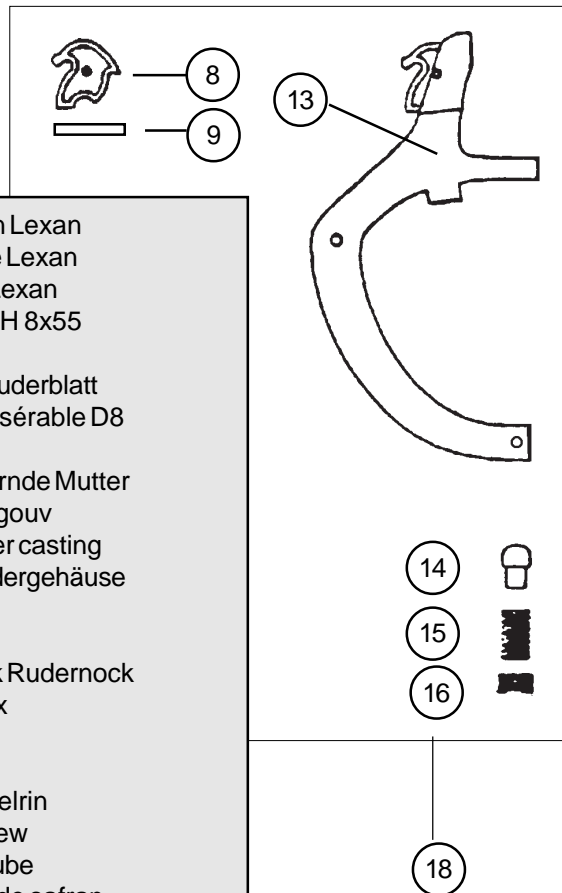

HC WAVE Club

Gouvernail/Rudder assembly/Ruderbeschlag
99062112

2008

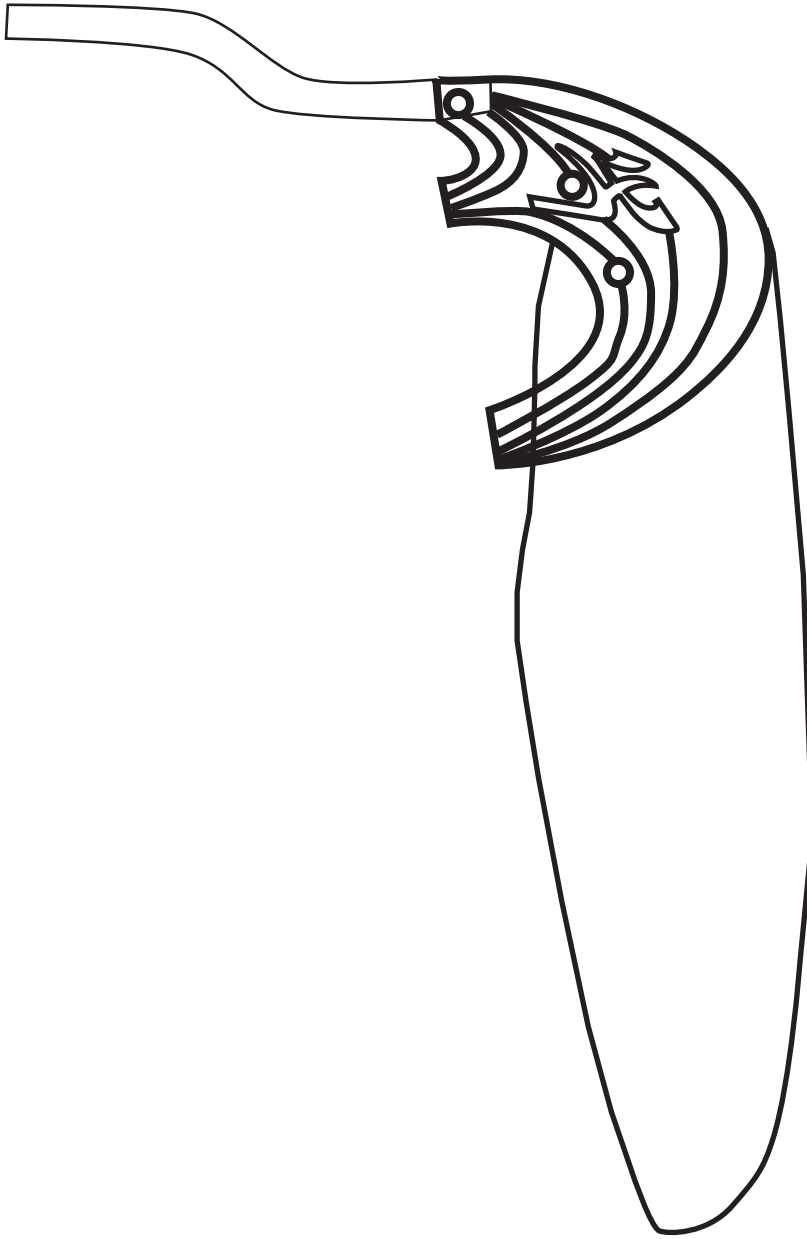

HC WAVE Club

Traverses/Crossbars/Holme

TRAVERSE AVANT/FRONT CROSSBAR/VORDERHOLM

99062610 (avant/prior/vor 2004)

1 - 14000025	Emplanture de mât Maststep Mastfusspfanne
2 - 14041709 (x10)	Coussinet Teflon Mast pivot bearing Teflonplättchen
3 - 16041756 (x10)	Axe + goupille Axe + cotter pin Achse + Sprengbolzen

99062605 (2004)

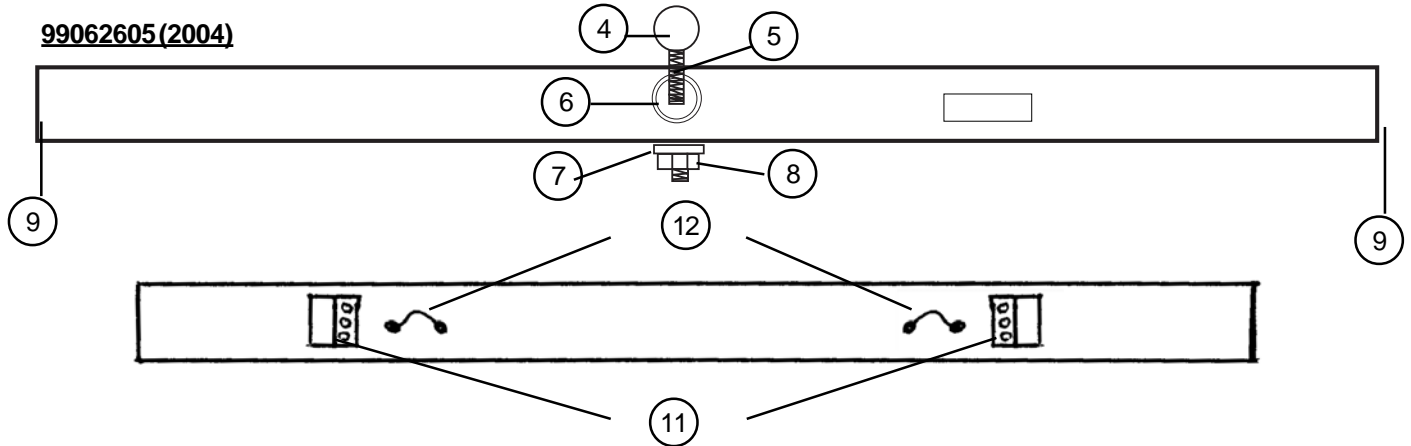

TRAVERSE ARRIERE/REAR CROSSBAR/ACHTERHOLM : 99062615

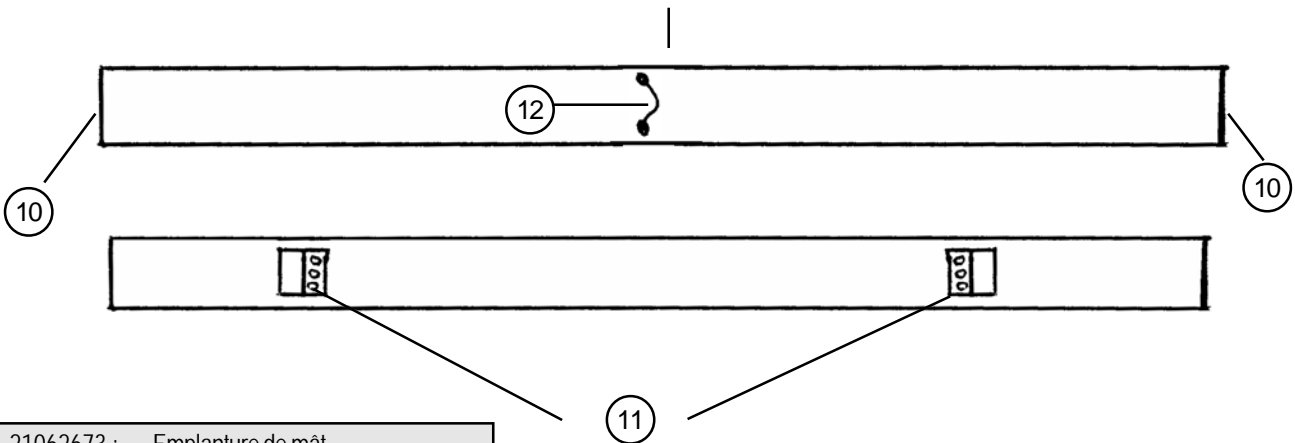

- | | |
|----------------|--|
| 4 - 21062673 : | Emplanture de mât
Mast step ball
Mastfussballe |
| 5 - 99219000 : | Tige filetée M16
(mm)
Mast step post
Mastfuss |
| 6 - 99220104 : | Erou HU 16 mm
Nut HU 16 mm
Mutter HU 16 mm |
| 7 - 99220735 : | Rondelle inox 16 mm
(x10)
Washer stainless steel
Inox Scheibe |
| 8 - 99220110 : | Erou indessérable 16 mm
Nylstop nut
Selbstsichernde Mutter |

- | | |
|------------------------|---|
| 9 - 99056061 | Bouchon traverse AV
Front crossbar end cap
Vorderholm-Endstück |
| 10 - 99056062 | Bouchon de traverse AR
Rear crossbar end cap
Achterholm-Endstück |
| 11 - 99056530 | Equerre d'arrêt traverse
Crossbar stop plate
Vorderholm-Arretierung |
| 12 - 99220216
(x10) | Pontet
Eyestraps
Bügel |

2007

HC WAVE Club

Barre d'accouplement renforcée & Stick
Tiller crossbar reinforced & Tiller extension
Anlenkstange verstärkt & Pinengelenk

BARRE ACCOUPLEMENT RENFORCEE COMPLETE/TILLER
CROSSBAR REINFORCED COMPLETE/ANLENKSTANGE
VERSTÄRKT KOMPLET = 99062260

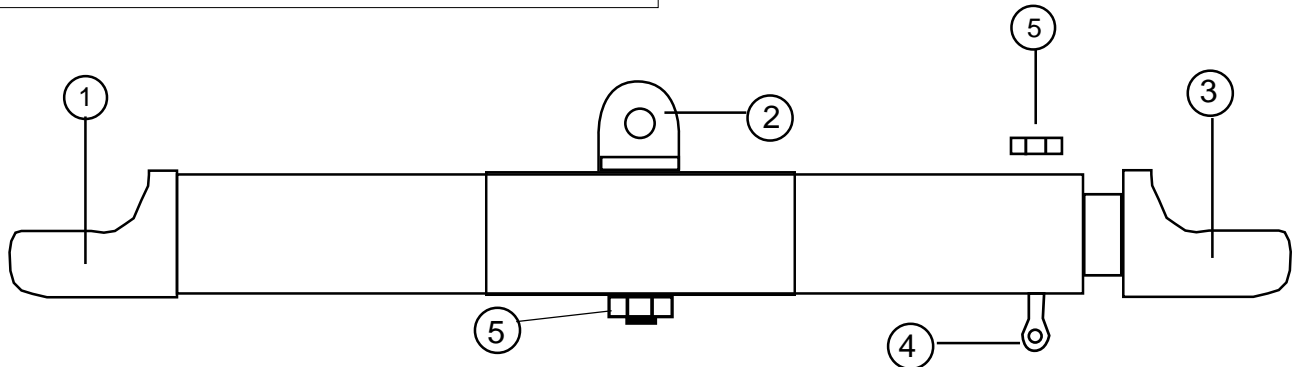

- 1- 99000005: Embout à rotule
Tiller end cap
Pinnenendstück
- 2 - 99220955 (x4): Vis violon
Violon screw
Schraube für Pinngelenk
- 3 - 99000010: Coulisseau réglable
Adjustable tiller end cap
Gleiter
- 4 - 99056269 (x10): Vis manillon
Tiller adjusting screw
Schraube
- 5 - 99056239 (x10): Ecrou indessérable D8
Nylstop nut D8
Selbstsichernde Mutter D8

- 6 - 99500380: Kit d'articulation TCM
Tiller connector kit TCM
Verbindungsgelenk TCM
- 7 - 99500331: Demi-pallier
Rubberspacer
Distanzhülse
- 8 - 99220965 (x20): Demi-bille nylon
Half ball nylon
Nylon Halbkugel
- 9 - 99500336 (x10): Ressort TCM
TCM spring
TCM-Feder
- 10 - 99220875 (x10): Vis TH 6 x 50
TH screw
TH Schraube
- 11 - 99220745 (x10): Rondelle inox
Stainless washer
Unterlegscheibe
- 12 - 99056238 (x10): Ecrou indessérable D6
Nylstop nut D6
Selbstsichernde Mutter D6

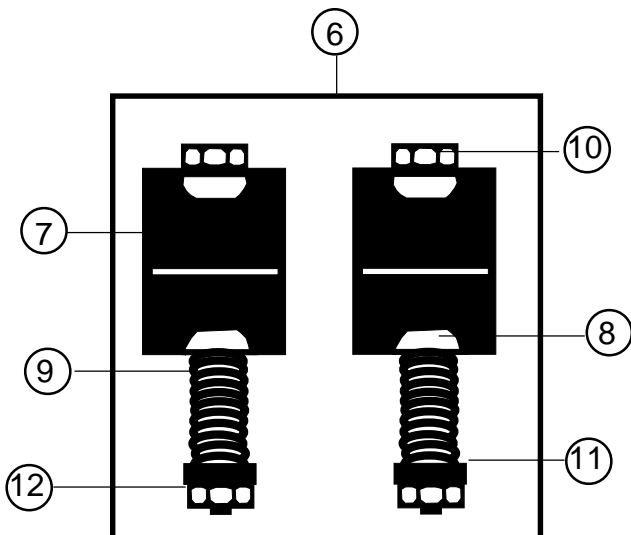

- 13 - 99062305 : Stick Alu
Aluminium tiller extension
Pinnenausleger Aluminium
- 14 - 14061316:
(x10) Embout stick alu
Aluminium extension cap
Pinnenendstück Aluminium
- 15 - 14061321 :
(x10) Chape articulation stick
Stick articulation

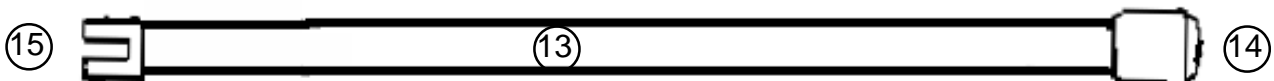

2008

HC WAVE Club

Barre d'accouplement renforcée & Stick
Tiller crossbar reinforced & Tiller extension
Anlenkstange verstärkt & Pinengelenk

BARRE ACCOUPLEMENT RENFORCEE COMPLETE/TILLER
CROSSBAR REINFORCED COMPLETE/ANLENKSTANGE
VERSTÄRKT KOMPLET = 99062200

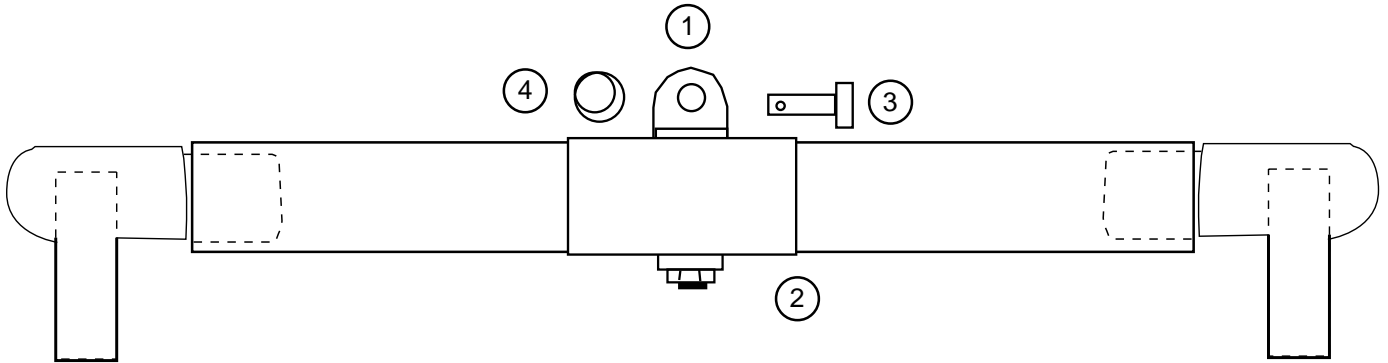

- | | |
|------------------------|---|
| 1 - 99220955 (x4): | Vis violon
Violon screw
Schraube für Pinnengelenk |
| 2 - 99056239 (x10): | Ecrou indessérable D8
Nylstop nut D8
Siebtsichernde Mutter D8 |
| 3 - 14061241 (x10): | Axe percé
Clevis pin
Bolzen |
| 4 - 99220230 (x10): | Anneau brisé
Split ring
Ring Splint |
| 5 - 99062305 : | Stick Alu
Aluminium tiller extension
Pinnenausleger Aluminium |
| 6 - 14061316:
(x10) | Embout stick alu
Aluminium extension cap
Pinnenendstück Aluminium |
| 7 - 14061321 : | Chape articulation stick
Stick articulation |

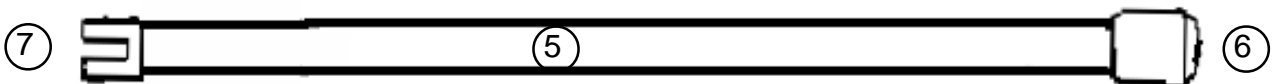

HC WAVE Club Mât/Mast/Mast

Avant/Prior/Vor 2004

Mât 1 pièce/1 piece Mast/Einteiliger Mast = **99042700**
Mât 2 pièces/2-piece mast /Zweiteiliger Mast = **99042710**

Jeux de câbles HW/Cable set/Käbelsatz = **99070500**
Sac d'accastillage/Rig bag/Takelagesack = **99080300**

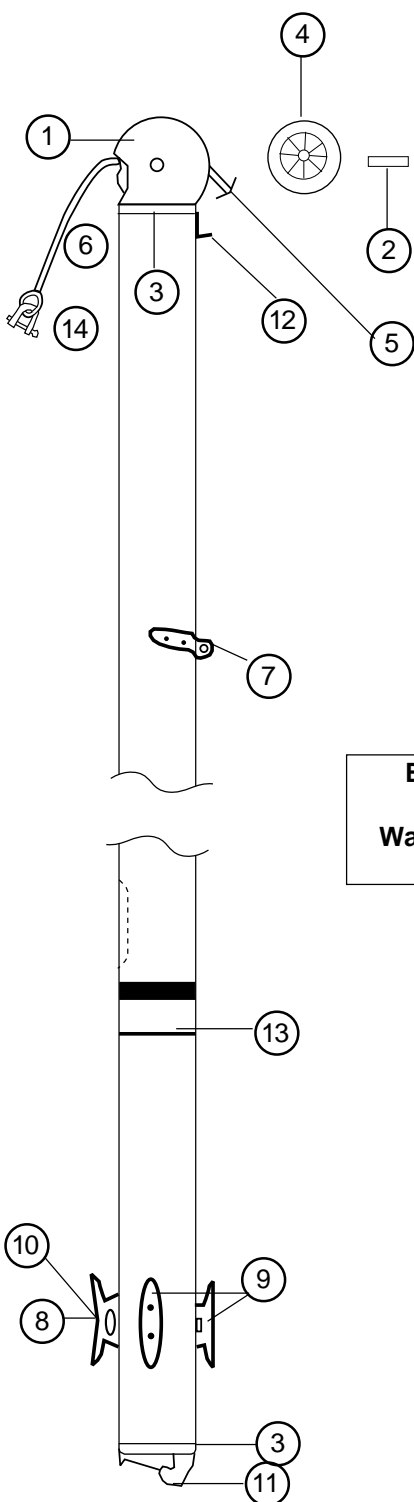

**Bouchons étanches/
waterproof plugs/
Wasserdicht Dichtungen
99210075 (x10)**

- | | |
|-------------------------|---|
| 1- 14000015: | Tête de mât noire
Black mast head
Mastkopf schwarz |
| 2- 14041711: | Axe tête de mât
Sheave pin mast head
Bolzen Mastkopf |
| 3- 14042720:
(x10) | Sceau mât
Mast plug
Mast Abdichtung |
| 4- 14041712: | Réa
Nylon sheave
Rolle |
| 5- 13041751: | Drisse câble GV
Main halyard wire
Grossfall Kabel |
| 6- 14070460: | Drisse cordage
Halyard rope
Fall |
| 7- 14041722: | Ferrure capelage
Mast tang
Mastbeschlag |
| 8- 14041720 :
(x10) | Taquet étarq amure
Downhall cleat
Klampe |
| 9- 99220760 :
(x10) | Taquet de drisse
Halyard Cleat
Niederholer Mastklemme |
| 10- 99220765 :
(x10) | Vis taquet
Screw
Schraube |
| 99220325 | Ecrou carré amure
Tack square nut
Viereckmutter |
| 11- 14000020: | Base mât noire
Black mast base
Mastfuss schwarz |
| 12- 14041721 : | Hook de drisse
Halyard hook
Fallhaken |
| 13- 14041723: | Autocollant de sécurité
Mast caution label
Sicherheitsaufkleber |
| 14- 99220665 :
(x10) | Manille 6 mm
Shackle 5 mm
Schäkel 6 mm |

HC WAVE Club

Mât/Mast/Mast

2004

Mât 1 pièce/1 piece Mast/Einteiliger Mast = **99042705**
 Mât 2 pièces/2-piece mast /Zweiteiliger Mast = **99042715**

Jeux de câbles HW/Cable set/Käbelsatz = **99070502**

Sac d'accastillage/Rig bag/Takelagesack = **99080300**

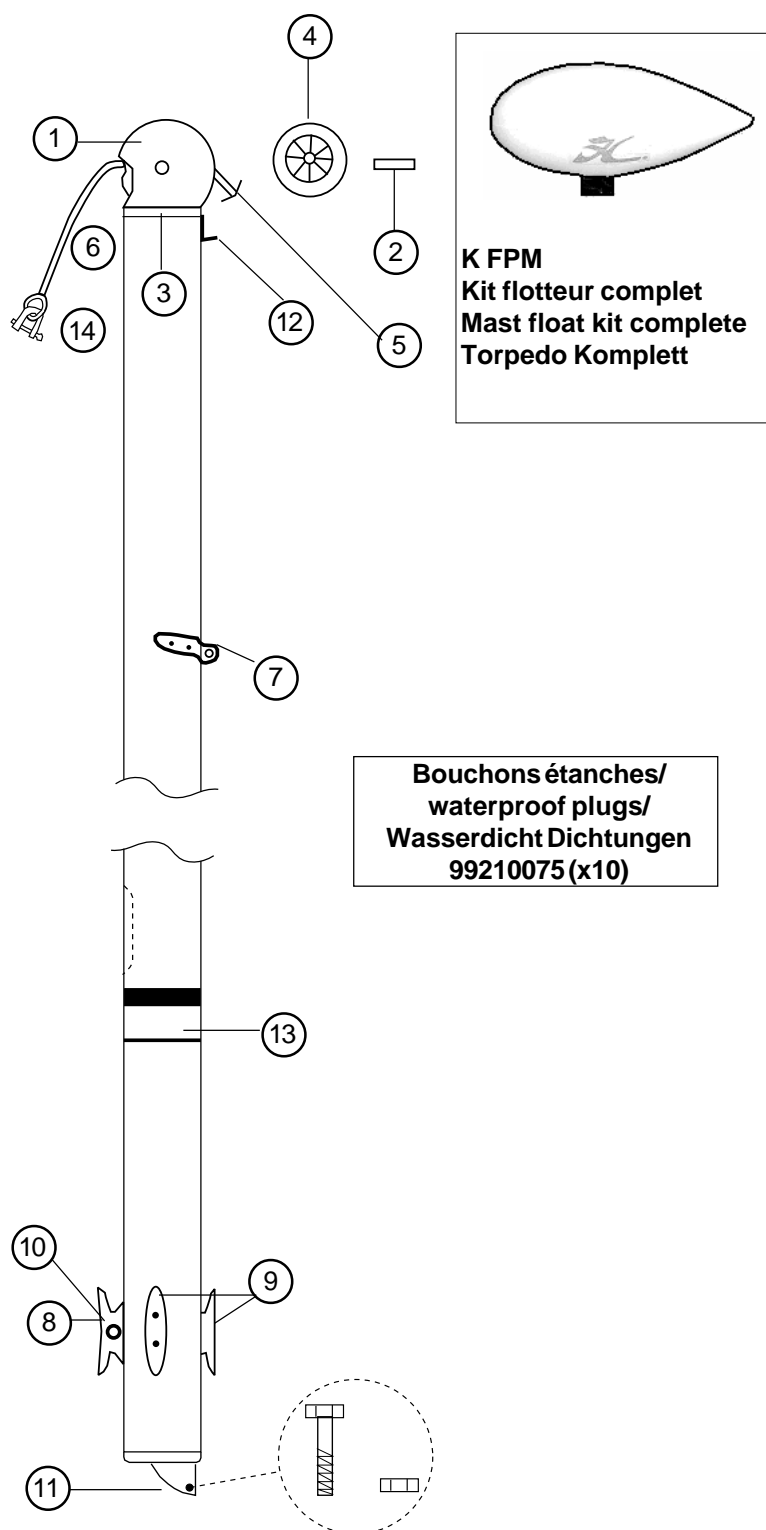

K FPM
Kit flotteur complet
Mast float kit complete
Torpedo Komplett

**Bouchons étanches/
 waterproof plugs/
 Wasserdicht Dichtungen**
99210075 (x10)

- | | |
|-------------------------|---|
| 1- 14000015: | Tête de mât noire
Black mast head
Mastkopf schwarz |
| 2- 14041711: | Axe tête de mât
Sheave pin mast head
Bolzen Mastkopf |
| 3- 14042720:
(x10) | Sceau mât
Mast plug
Mast Abdichtung |
| 4- 14041712: | Réa
Nylon sheave
Rolle |
| 5- 13041751: | Drisse câble GV
Main halyard wire
Grossfall Kabel |
| 6- 14070460: | Drisse cordage
Halyard rope
Fall |
| 7- 14041722: | Ferrure capelage
Mast tang
Mastbeschlag |
| 8- 14041720 :
(x10) | Taquet étarq amure
Downhall cleat
Klampe |
| 9- 99220760 :
(x10) | Taquet de drisse
Halyard Cleat
Niederholer Mastklemme |
| 10-99220765 :
(x10) | Vis taquet
Screw
Schraube |
| 99220325 | Ecrou carré amure
Tack square nut
Viereckmutter |
| 11- 13600010: | Base mât 2004
Mast base 2004
Mastfuss 2004 |
| 12- 14041721 : | Hook de drisse
Halyard hook
Fallhaken |
| 13- 14041723: | Autocollant de sécurité
Mast caution label
Sicherheitsaufkleber |
| 14- 99220665 :
(x10) | Manille 6 mm
Shackle 6 mm
Schäkel 6 mm |

HC WAVE Club

Haubans/Shrouds/Wanten

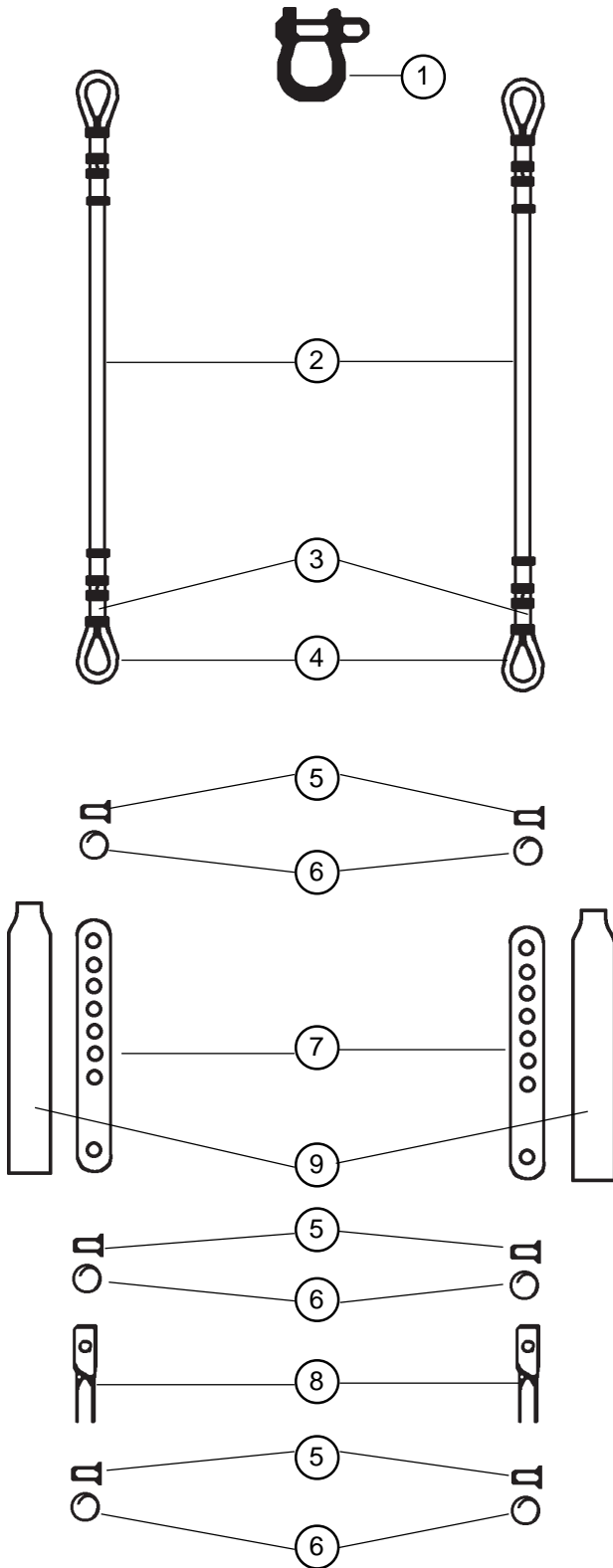

1-99220210 (x10): Manille Lyre 8mm
Shackle 8 mm
Mastschäkel 8 mm

2- 99060515 (2003): Hauban
99060520 (2004) Shroud
Want

3- 99056249: Manchon D4
(x10) Sleeve
Hülse

4- 99300058 (x10): Cosse std
Thimble
Kausch Std

5- 99056230 (x10): Axe percé lat. ridoir
Clevis pin
Bolzen für Wanteisen

6- 99220230 (x10): Anneau brisé
Split ring
Ringsplint

7- 99220650 (x5): Latte universelle ridoir
Stay adjuster
Wanteisen

8- 16060313 (x10): Chape de hauban
Toggle
Wanten Toggle

9- 99500369 (x10): Protège lattes ridoires
Shroud adjuster cover
Wantenschutz

HC WAVE Club

Etai & brides/Forestay and bridles/Vorstag und Hahnepot

Hobie Cat Wave : Eclaté de pièces détachées / Illustrated part guide/Explosionszeichnung (2007-2008)

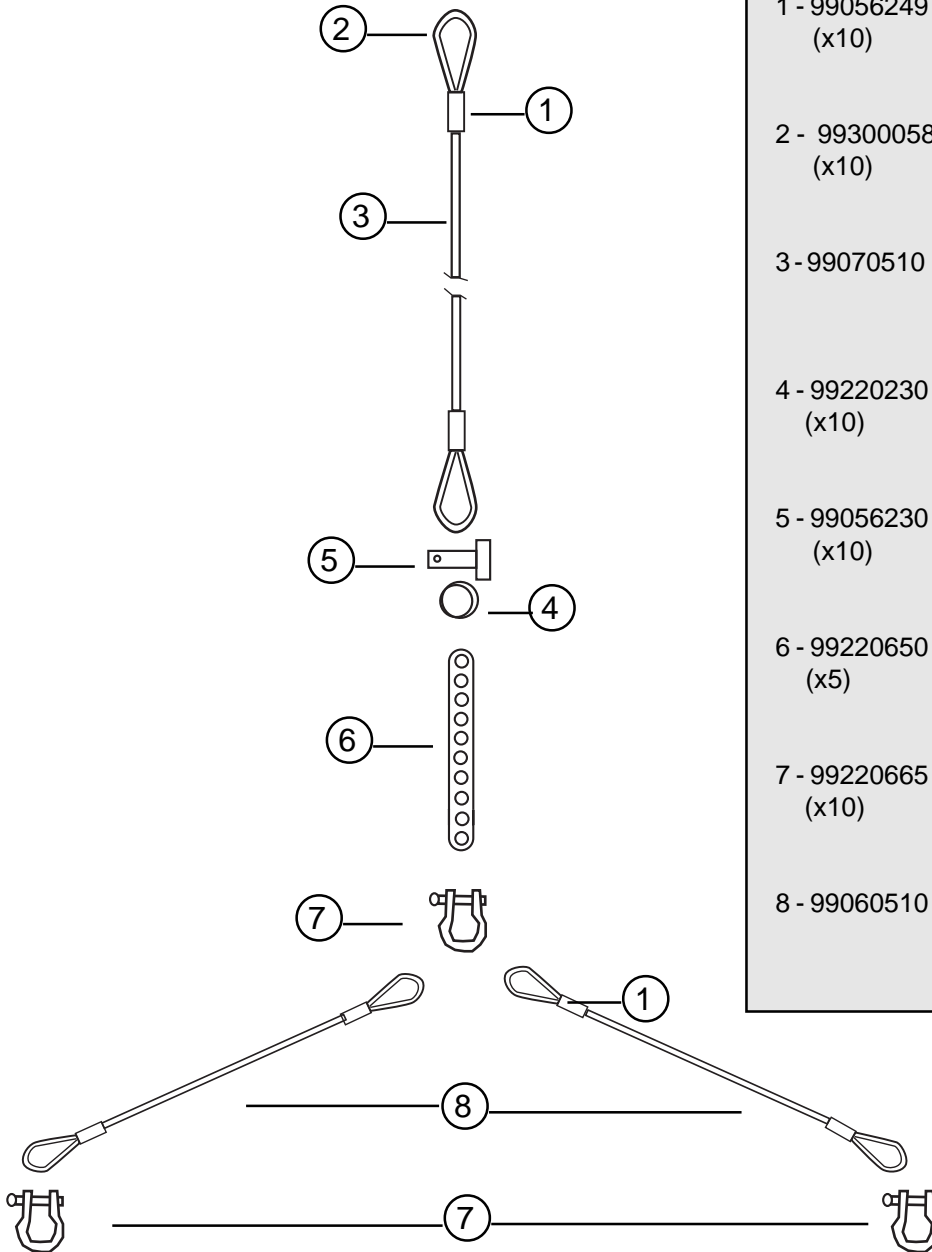

1 - 99056249 : (x10)	Manchon D4 Sleeve Hülse
2 - 99300058 : (x10)	Cosse std Thimble Kausch Std
3 - 99070510	Etai cable Forestay Vorstag Kabel
4 - 99220230 : (x10)	Anneau brisé Split ring Ringsplint
5 - 99056230 : (x10)	Axe percé Clevis pin Bolzen für Locheisen
6 - 99220650 : (x5)	Latte universelle Stay adjuster Locheisen
7 - 99220665 : (x10)	Manille lyre 6 mm Shackle 6 mm Schäkel 6 mm
8 - 99060510 :	Bride Bridle Hahnepot

HC WAVE Club
 Trampoline/Trampoline/Trampolin

Avant/Front/Vorder

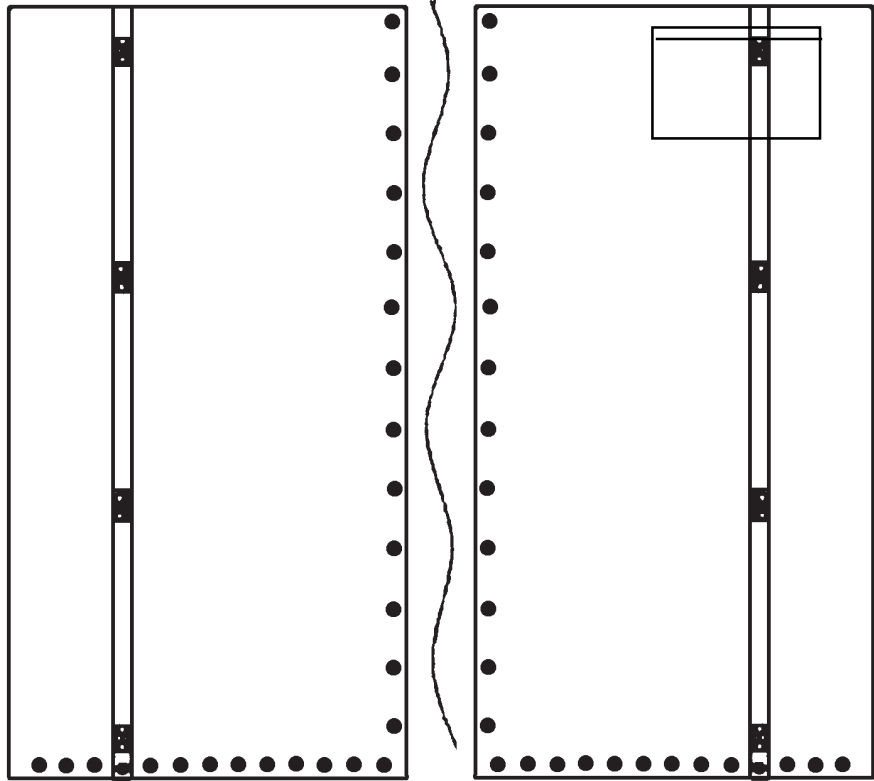

Arrière/Rear/Hinten

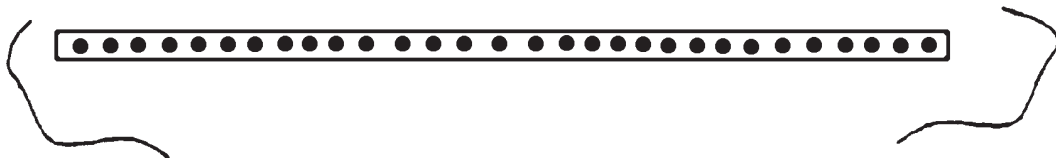

TRAMPOLIN 3 PIECES/3 PIECE TRAMPOLINE/3TEILIGER TRAMPOLIN
 99025005 blanc/white/weiss
 99025215 Bleu/blue/blau

HC WAVE Club
Grand-voile/Main sail/Gross-Segel

16990001	Grand-voile HC Wave blanche HC Wave white mainsail HC Wave Großsegel weiß
16990002	Grand-voile HC Wave couleur HC Wave coloured mainsail HC Wave Großsegel farbig
99034010	Jeu de lattes HC Wave HC Wave batten set HC Wave - Lattensatz
99070400	Sac de cordage GV + trampoline Rope bag mainsail and trampoline Linetasche für Großsegel u. trampoline

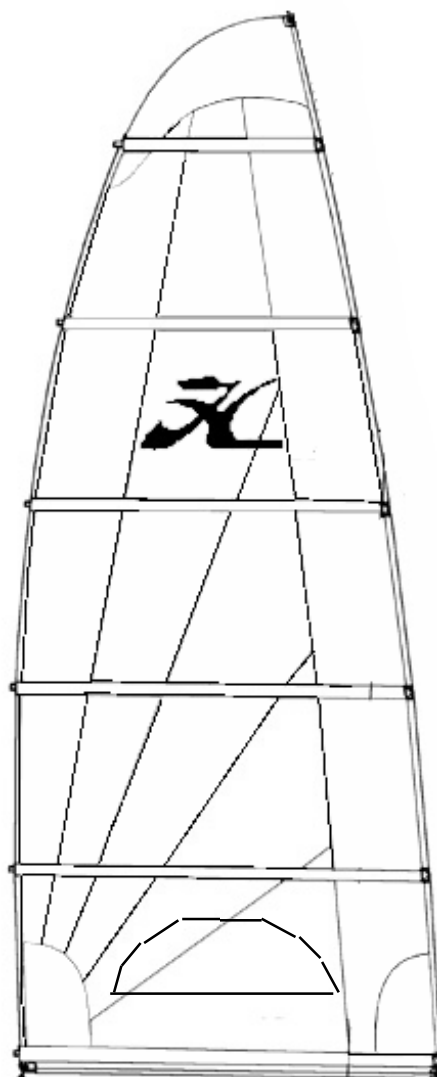

HC WAVE Club
Poulies/Main blocks/Blöcke

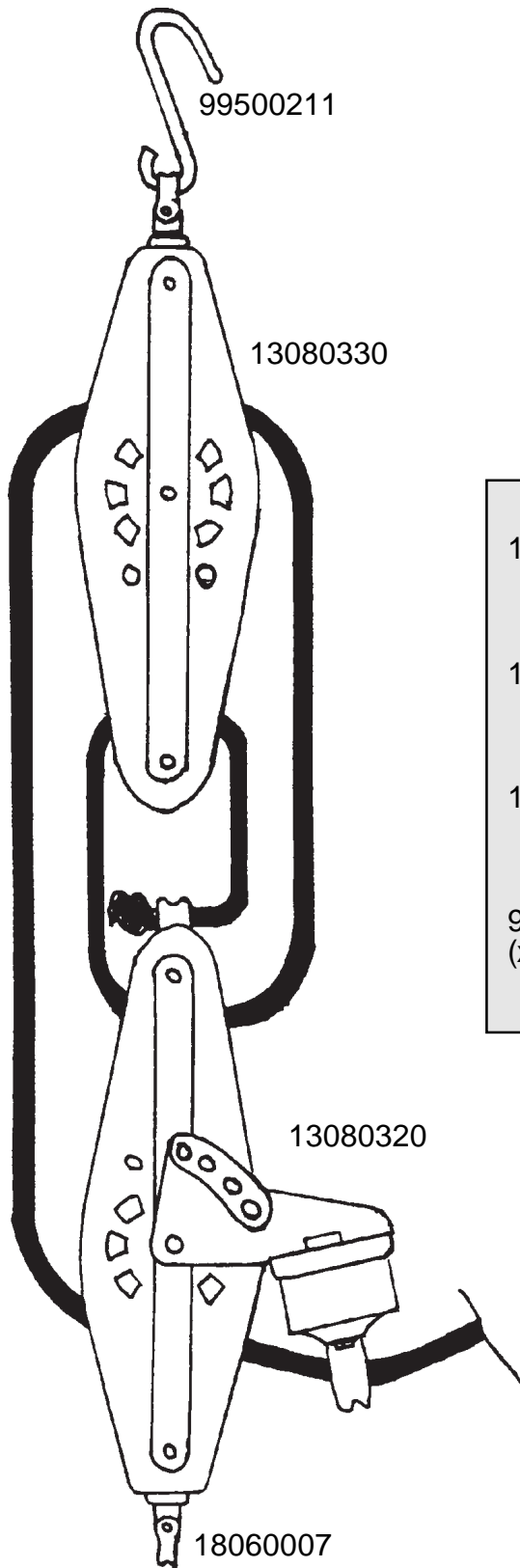

13080320	Poulie grand voile avec taquet Main block with cam cleat Block Gross-Segel mit Klemme
13080330	Poulie grand voile avec émerillon Main block with swivel Block Gross-Segel mit Wirbel
18060007	Manille de poulie Block shackle Blockschäkel
99500211 (x2)	Crochet grand voile Main hook Großsegel Haken

Hobie Cat Wave : Eclaté de pièces détachées / Illustrated part guide/Explosionszeichnung (2007-2008)

HC WAVE club Turbo

Kit de foc - Jib Kit - Fockkit
99600045

- | | |
|----------------|-----------------------------------|
| 1 - 99056249 : | Manchon D4 |
| (x10) | Sleeve |
| | Hülse |
| 2 - 99300058 : | Cosse std |
| (x10) | Thimble |
| | Kausch Std |
| 3 - 99070520 | Estrope |
| | Pigtail |
| | Pigtail |
| 4 - 18042715 : | Manille longue |
| (x5) | Long shackle |
| | Länge Schäkel |
| 5 - 99500250 : | Poulie drisse de foc |
| | Jib halyard block |
| | Fockfallumlenblock |
| 6 - 99220660 : | Manille lyre 4 mm |
| (x10) | Shackle 4 mm |
| | Schäkel 4 mm |
| 7 - 99080010 : | Tourelle de foc gauche + support |
| | Jib block +plate left |
| | Fockschotsblock mit Platte links |
| 99080015 : | Tourelle de foc droite+ support |
| | Jib block +plate right |
| | Fockschotsblock mit Platte rechts |

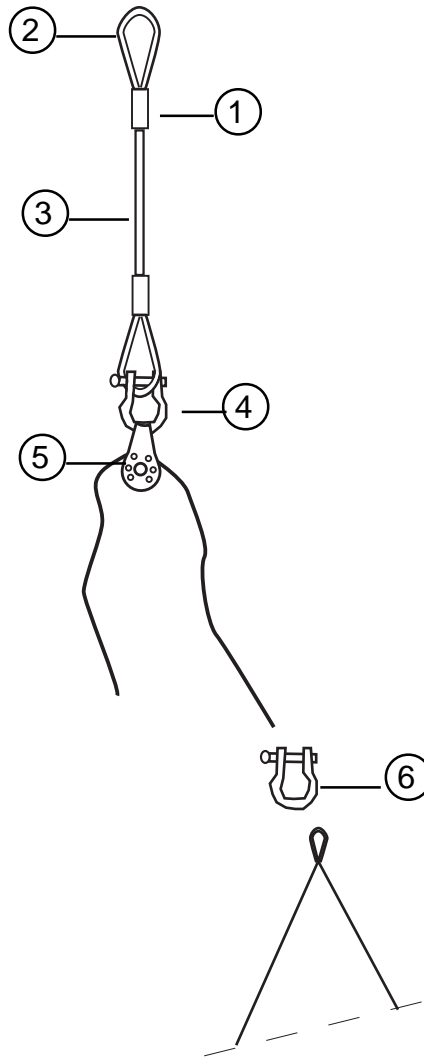

sur les coques/on the hulls/auf der Rumpfe

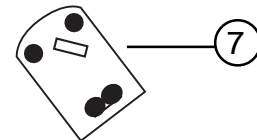

- 16990005 : Foc blanc/White jib/Fock weiss
16990010 : Foc couleur/Coloured jib/Fock farbig

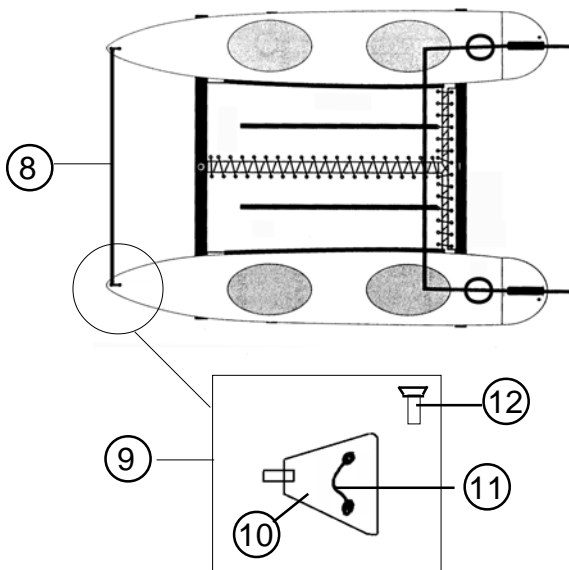

- | | |
|---------------|-------------------------------------|
| 8 - 99062320 | Barre de maintien parallèle |
| | Parallel bow spreader bar |
| | Holm Turbo |
| 9 - 99062330 | Embout barre de maintien |
| | Parallel bar end cap |
| | Turbo Holm-Endstück |
| 10 - 99056520 | Platine barre de maintien |
| | Plate for parallel bow spreader bar |
| | Platte Holm Turbo |
| 11 - 99056265 | vis platine |
| (x10) | plate screw |
| | Platte-Schraube |
| 12 - 99220216 | Pontet |
| (x5) | Eyestrap |
| | Bügel |